

TOTAL MILES  
 Township Road System 87.20\*  
 State Highway System 34.14  
 Total 121.34

\* Includes ACT 32 Turnback Mileage of 0.16

POPULATION 20,458  
 (2020 Census)

LEGEND

- LIMITED ACCESS HIGHWAY
- STATE ROUTE AND NUMBER
- STATE MAINTAINED BRIDGE ON TOWNSHIP ROAD
- TOWNSHIP ROAD, NUMBER AND SEGMENT LENGTH IN MILES
- IMPASSABLE TOWNSHIP ROAD
- TURNBACK TOWNSHIP ROAD
- OTHER ROAD
- RAILROAD (IN SERVICE)
- RAILROAD ABANDONED (TRACK RETAINED)
- STATE BOUNDARY
- COUNTY BOUNDARY
- TOWNSHIP BOUNDARY
- CITY OR BOROUGH BOUNDARY
- MUNICIPAL BUILDING
- SPLIT MILEAGE BETWEEN MUNICIPALITIES

- 200 LONGVIEW RD
- 201 LOZARK RD
- 202 KEEN RD
- 203 BROWNBACK RD
- 204 POSSUM HOLLOW RD
- 205 LIGHTCAP RD
- 206 AIRPORT RD
- 207 RUFFERT RD
- 208 PENN RD
- 209 FRUITVILLE RD
- 210 PROSS HILL RD
- 211 SMITH RD
- 212 ALBERT RD
- 213 HOUCK RD
- 214 MALL RD
- 215 GIBBE RD
- 216 STEINMETZ RD
- 217 SHAMPOOER RD
- 218 LAVER RD
- 219 DERLOFF RD
- 220 BRAGG RD
- 221 BETTY LA
- 222 ROBERTA LA
- 223 SHADY LA
- 224 SARKENY RD
- 225 SHERIDAN RD
- 300 CHURCH RD
- 301 REDMERE RD
- 302 BORATEN RD
- 303 SAGO RD
- 304 PENNHURST RD
- 305 RAILROAD ST
- 307 TRINLEY DR
- 308 WILL LA
- 309 MAJOR RD
- 310 MAJOR HOLLOW RD
- 311 FEMALE LA
- 312 BENNER RD
- 315 DAK LA
- 316 CHERY LA
- 318 LIMERICK RD
- 319 SPRINGFORD RD
- 320 KULLER RD
- 321 ZELGER RD
- 322 WETKA RD
- 323 HIGHLAND RD
- 324 HANFORD RD
- 325 GRATERHERR RD
- 326 HOCKEY RD
- 327 WINE RUN RD
- 328 WEND RD
- 400 WALTERS LA
- 401 WANEL DR
- 402 KING RD
- 403 COUNTRY CLUB RD
- 404 SUNSET RD
- 405 CHAPEL RD
- 406 DAK ST
- 407 SPRING ST
- 408 NINTH ST
- 409 ROVERSDOWN RD
- 410 BUCKWALTER RD
- 411 OLD MILL RD
- 412 SOUHER RD
- 413 SPRING LAKE RD
- 414 HEFFNER RD
- 415 SCHOOL RD
- 416 SAYLOR RD
- 417 CEMETERY RD
- 418 DEERFIELD RD
- 419 MEAVER LA
- 420 REIFSHOEDER RD
- 421 COTTENHALL RD
- 422 COLLINS LA
- 423 DONLEAVY CIR
- 424 HAINES DR
- 425 KOCH DR
- 426 KIBBLHOUSE DR
- 427 DETWILER DR
- 428 GALLE WAY
- 429 SHANNON WAY
- 430 SEVENTH AV
- 431 HUNLEY DR
- 432 MELISSA LA
- 433 INDUSTRIAL PARKY
- 434 DEISINGER DR
- 435 MARIA LA
- 436 MOSES LA
- 437 BLOSSOM LA
- 438 LAND'S CREEK LA
- 439 JOAC CIR
- 440 SARA LA
- 441 HENRY DR
- 442 MILLER CIR
- 443 WILLIAM PENN CIR
- 444 ELID CIR
- 445 WOLFELD DR
- 446 SPRING HAVEN CIR
- 447 TAXISTOCK DR
- 448 LAUREL DR
- 449 AZALEA CIR
- 450 HICKORY GROVE DR
- 451 BAYBERRY DR
- 452 WISTERIA DR
- 453 STAMBOE DR
- 454 MULBERRY DR
- 455 SPRUCEWOOD DR
- 456 BUTTWOOD DR
- 457 HEMLOCK WAY
- 458 CROWNPOINT DR
- 459 QUEEN LA
- 460 VICTORY WAY
- 461 LION CT
- 462 PACEANT CT
- 463 ARONWINE DR
- 464 CHEROKEE CT
- 465 APACHE LA
- 466 AURA LA
- 467 LORRAINE RD
- 468 FOX DR
- 470 ABBEY DR
- 471 SHAMROCK CT
- 472 PATRICK WAY
- 473 KILNARY WAY
- 474 BRADFORD CT
- 475 DONEGAL CT
- 476 HEATHER DR
- 477 THORNBERY WAY
- 478 TURRET DR
- 479 LARCHWOOD DR
- 480 WERLON DR
- 481 SAUCO CIR
- 482 WOODCREST CIR
- 483 FUNK DR
- 484 COLIN CT
- 485 MOODY RD
- 486 WALSH RD
- 487 DUBLIN CT
- 488 FIELSTONE DR
- 489 BRISTWELL LA
- 490 GRISTWELL LA
- 491 KING WAY
- 492 WEDAL DR
- 493 CASTLE DR
- 494 ANDSON DR
- 495 ROSE CT
- 496 PERRY CT
- 497 PARNELL LA
- 498 LEMELYN LA
- 499 EDMONDS DR
- 500 HARTNETT LA
- 501 KNIGHT DR
- 502 LONG MEADOW RD
- 503 SOMERSET CIR
- 504 BUCKLEY CIR
- 505 GREEN VIEW CIR
- 506 AUTUMN LA
- 507 ARBOR CT
- 508 ELLIOT CT
- 509 CONNOR DR
- 510 BIRMAK CT
- 511 BARTLETT DR
- 512 TANGLEWOOD DR
- 513 BRADFORD DR
- 514 ASHLEY DR
- 515 OSTRONGHIE CIR
- 516 GRANDVIEW DR
- 517 HENRIETTA LA
- 518 LEE DR
- 519 ROSEWOOD TRAIL
- 520 SUMMERBELL LA
- 521 RENEE CIR
- 522 JESSICA CIR
- 523 DURHAM CIR
- 524 ASHFORD WAY
- 525 LINDSEY CIR
- 526 SUN VALLEY DR
- 527 ORAKE RUN
- 528 SUNNY BROOK RD
- 529 BRIDGEMAR CIR
- 530 WILLOW WOOD DR
- 531 ASHBROOK DR
- 532 ST ANDREW BLVD
- 533 SANDTRAP DR
- 534 DUSSELDORF DR
- 535 GLENAGLES RD
- 536 LONGCROSS RD
- 537 TERTH AV
- 538 EVANSBROOKE LA
- 539 FOLEY CIR
- 540 PINE TREE RD
- 541 FOREST GLEN DR
- 542 SORLA CT
- 543 NICHOLAS CT
- 544 BELLA ROSA CT
- 545 WALNUT ST
- 546 ZORRO CT
- 547 BORATEN CIR
- 548 COLDRADO CT
- 549 ZARA DR
- 550 JONATHAN WAY
- 551 ANNETTE DR
- 552 EILEEN LA
- 553 INVERNESS CIR
- 554 FREDRICK CT
- 555 BAYHILL CIR
- 556 BRIDGEMAR LA
- 557 TURNBERRY DR
- 558 WENINGHREN CIR
- 559 OAK CREEK DR
- 560 GREEN MEADOW CT
- 561 RICHESBORO CT
- 562 WALTERS DR
- 563 FEE CT
- 564 PAR CIR
- 565 BUNKER WAY
- 566 PULLEN LA
- 567 BRIDGE CT
- 568 WHEATELLA CIR
- 569 TRISTEN BY
- 570 PHAETON WY
- 571 MOUNTAIN VIEW RD
- 572 PENNSTONE CT
- 573 WOODMONT CT
- 574 PALMER PL
- 575 WANGO WAY

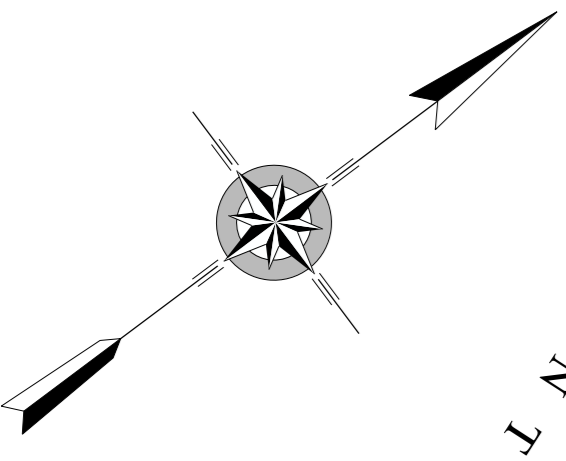
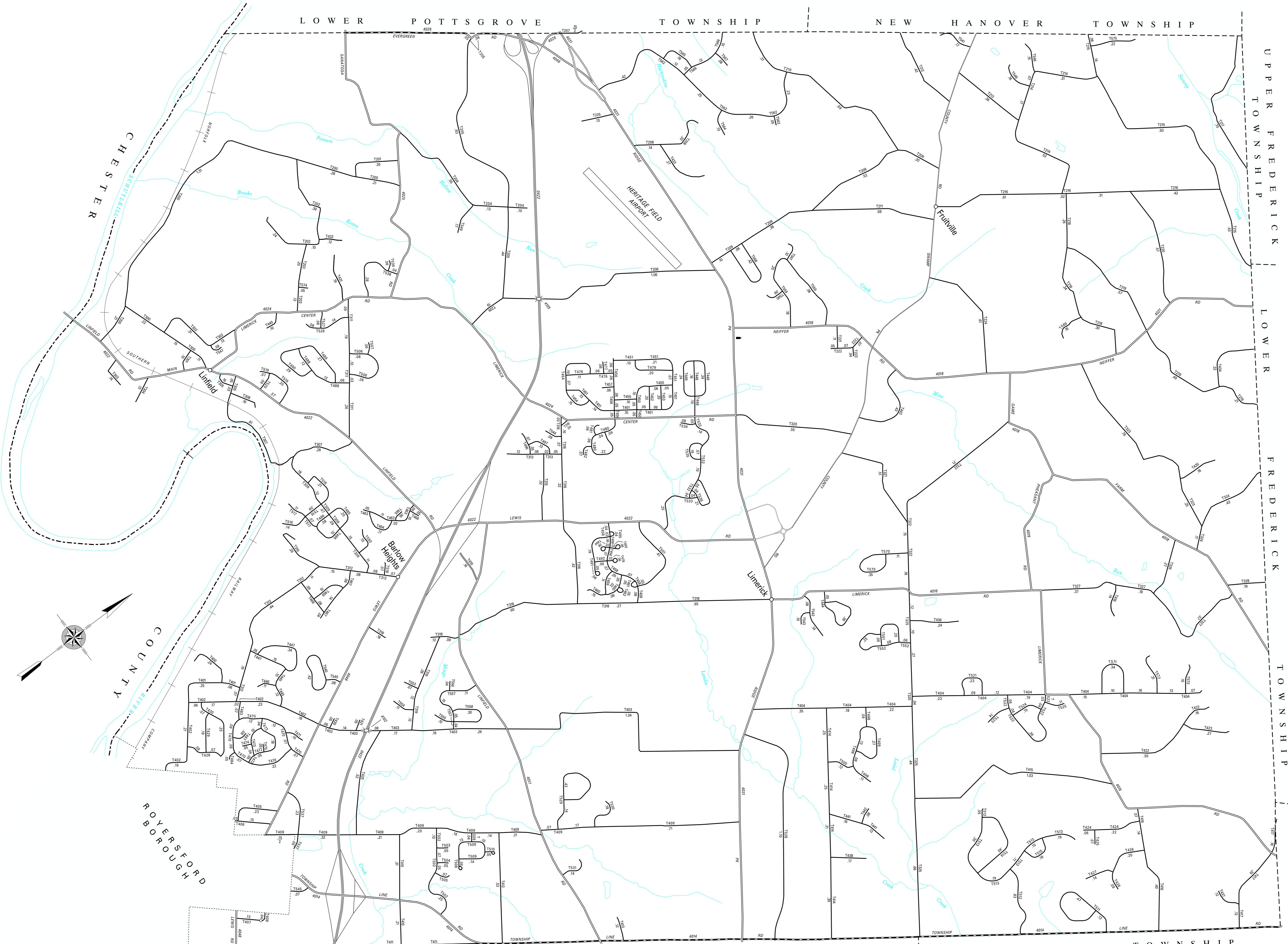

**LIMERICK**  
**SECOND CLASS TOWNSHIP MAP**  
**MONTGOMERY COUNTY**  
 PREPARED BY THE  
**PENNSYLVANIA DEPARTMENT OF TRANSPORTATION**  
**BUREAU OF PLANNING AND RESEARCH**  
**GEOGRAPHIC INFORMATION DIVISION**  
 IN COOPERATION WITH THE  
**U.S. DEPARTMENT OF TRANSPORTATION**  
**FEDERAL HIGHWAY ADMINISTRATION**  
 MUNICIPAL CODE 46 205  
 THIS MAP IS PUBLISHED AS A SUPPLEMENTAL  
 DOCUMENTATION OF LIQUID FUELS TAX FUND MILEAGES  
 REVISED PER FORM 990 DATED 10-31-23

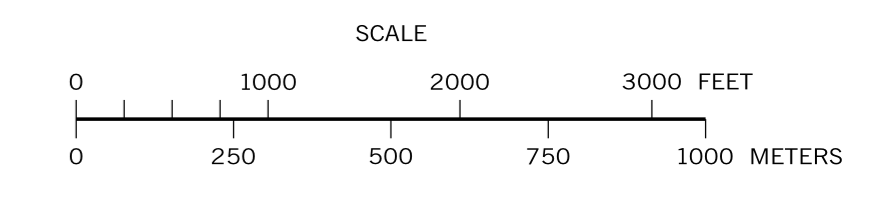

COPIES OF THIS MAP ARE AVAILABLE AT NOMINAL COST  
 CONTACT:  
 PENNSYLVANIA DEPARTMENT OF TRANSPORTATION  
 SALES STORE  
 HARRISBURG, PENNSYLVANIA 17105-3451  
 TELEPHONE: (717)787-6146  
 CREATED BY LIP 2-24-98 (REVISED 2-15-24)