



# Strategic Harbour Arterial

## Landscape Concept (Draft)

**Opus:** *an accomplished work,  
a creation, an achievement*



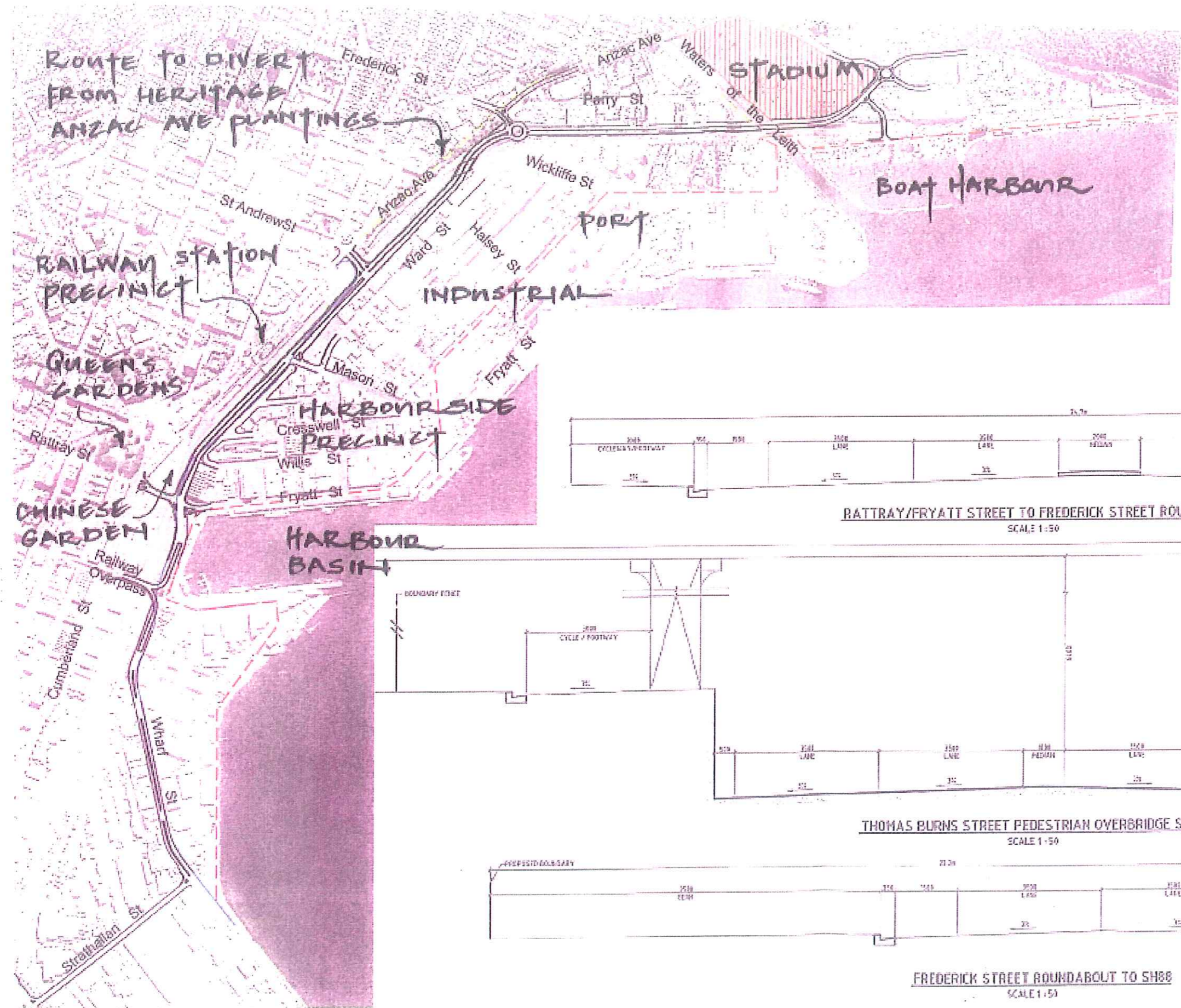

PROPOSED  
CYCLEWAY

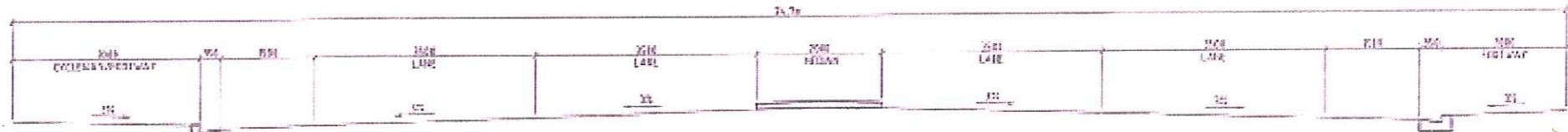

RATTRAY/FRYATT STREET TO FREDERICK STREET ROUNDABOUT  
SCALE 1:50

NOTE: ALL SECTIONS ARE  
LOOKING EAST

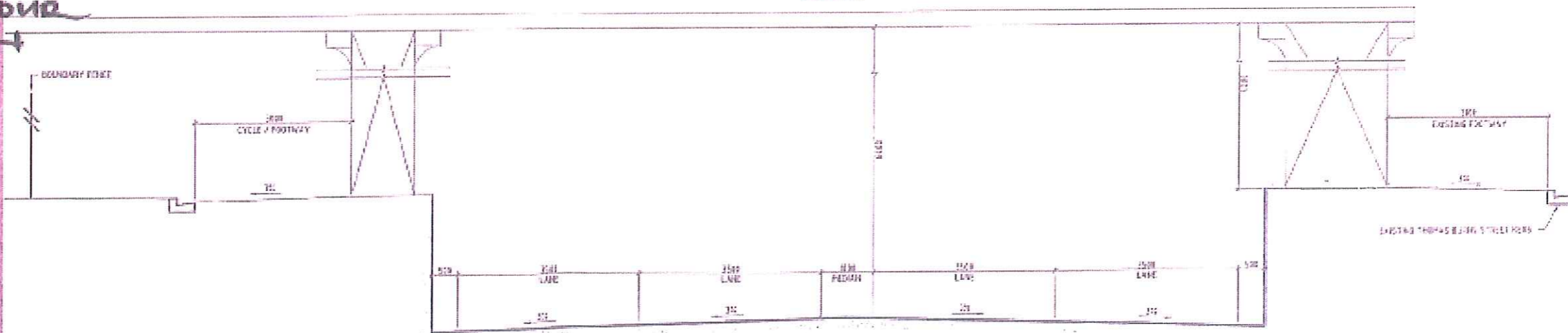

THOMAS BURNS STREET PEDESTRIAN OVERBRIDGE SECTION  
SCALE 1:50

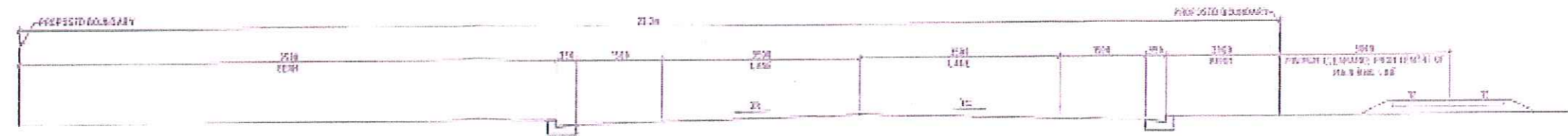

FREDERICK STREET ROUNDABOUT TO SH80  
SCALE 1:50



NOT FOR CONSTRUCTION

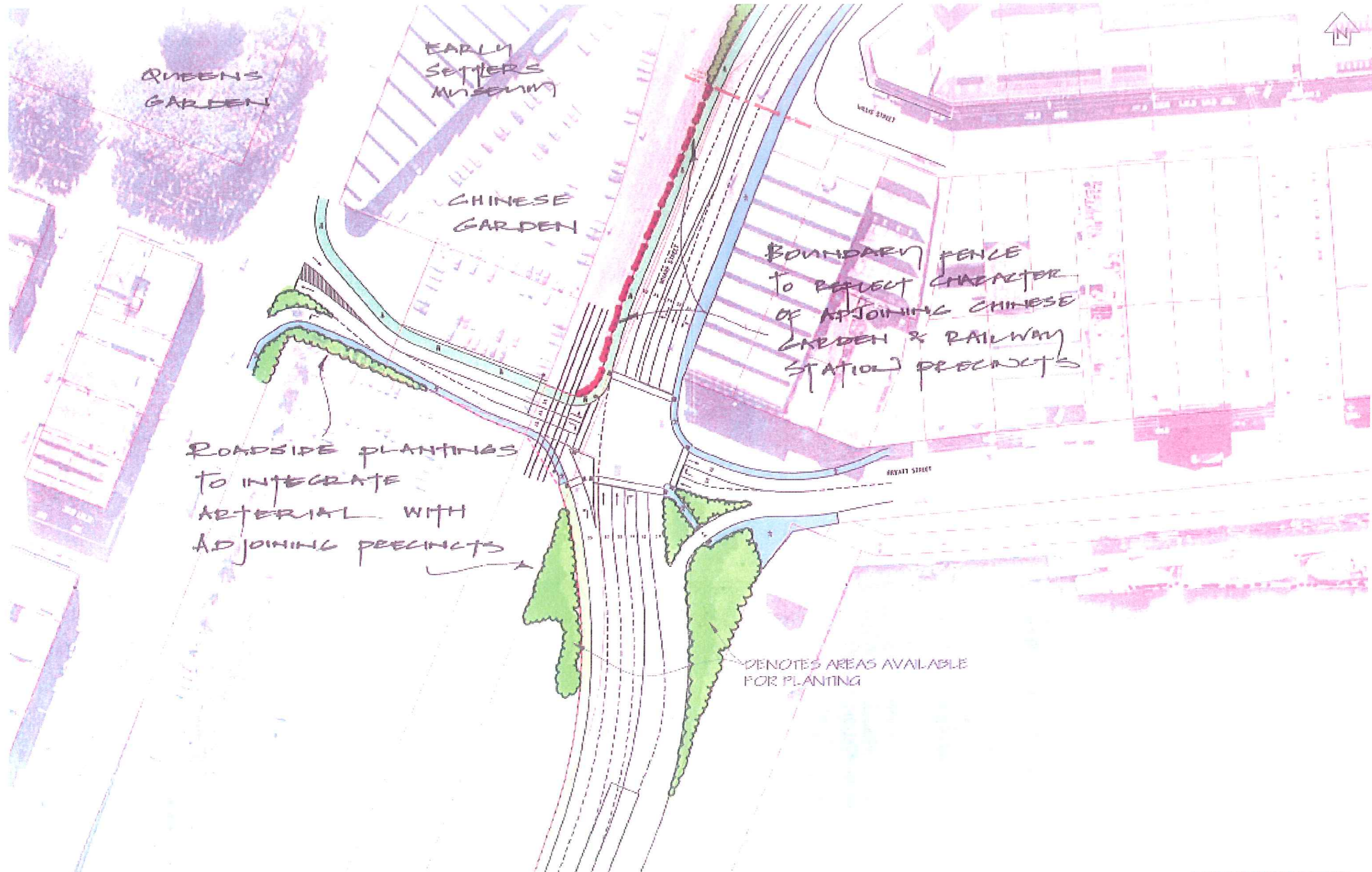

QUEENS GARDEN

EARLY SETTLERS MUSEUM

CHINESE GARDEN

BOUNDARY FENCE  
TO REFLECT CHARACTER  
OF ADJOINING CHINESE  
GARDEN & RAILWAY  
STATION PRECINCTS

ROADSIDE PLANTINGS  
TO INTEGRATE  
ARTERIAL WITH  
ADJOINING PRECINCTS

DENOTES AREAS AVAILABLE  
FOR PLANTING

NOT FOR CONSTRUCTION



DENOTES AREAS AVAILABLE FOR PLANTING

COUNCIL & PEDESTRIAN ROUTES DIVERTED FROM ARTERIAL EDGE THROUGH PLANTINGS IN AMENITY AREA DEVELOPED AS PART OF HARBOURSIDE PROJECT.

NOT FOR CONSTRUCTION



DENOTES AREAS AVAILABLE FOR PLANTING

STATION

POSSIBLE EXISTING PARKING STATION

AREAS TO BE DEVELOPED AS PART OF HARBOURSIDE PROJECT. OPPORTUNITY FOR PLANTING EDGE OF ARTERIAL & CYCLE & FOOTPATH DIVERSION.

ROAD EDGE LINE

HARBOUR STREET

NOT FOR CONSTRUCTION



GENEROUS PLANTED  
BORDER WITH CYCLE  
WAYS, FOOTPATHS  
& SEATING

DENOTES AREAS  
AVAILABLE FOR PLANTING

BACKS OF INDUSTRIAL  
BUILDINGS & FENCES  
BORDERING ARTERIAL  
TO BE ENHANCED WITH  
VINES & MURALS

NOT FOR CONSTRUCTION

INDICATIVE AREAS OF  
WOODLOT & AMENITY  
PLANTINGS INTEGRATING  
PROPOSED ROADWORKS  
INTO URBAN SETTING

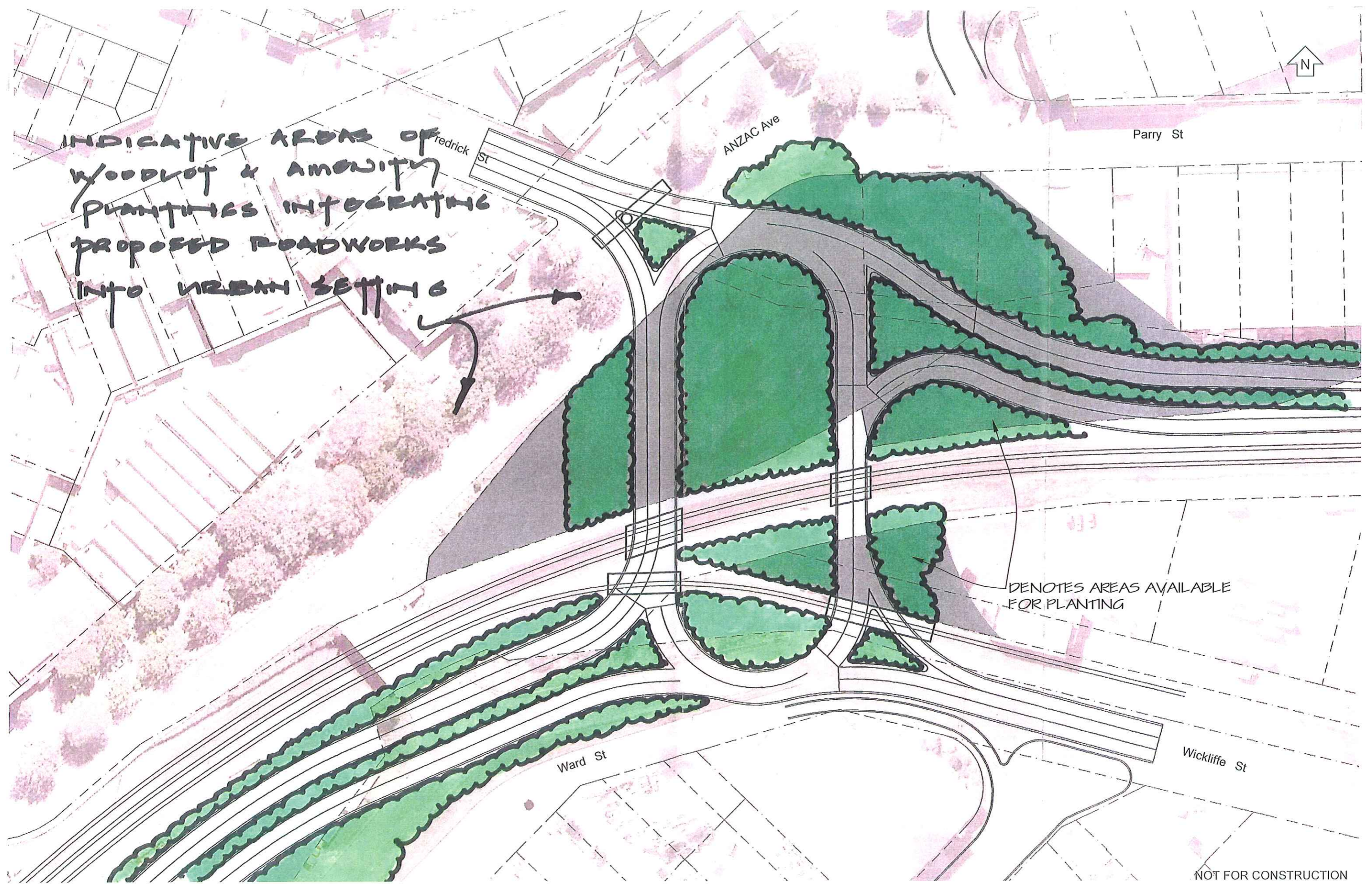

DENOTES AREAS AVAILABLE  
FOR PLANTING

NOT FOR CONSTRUCTION



FRYATT STREET



**LEGEND:**  
 - - - - - PROPOSED/EXISTING ROAD WITH A SIDEWALK BOULEVARD  
 - - - - - PROPOSED/EXISTING ROAD TO CITY / CONGESTION

NOT FOR CONSTRUCTION



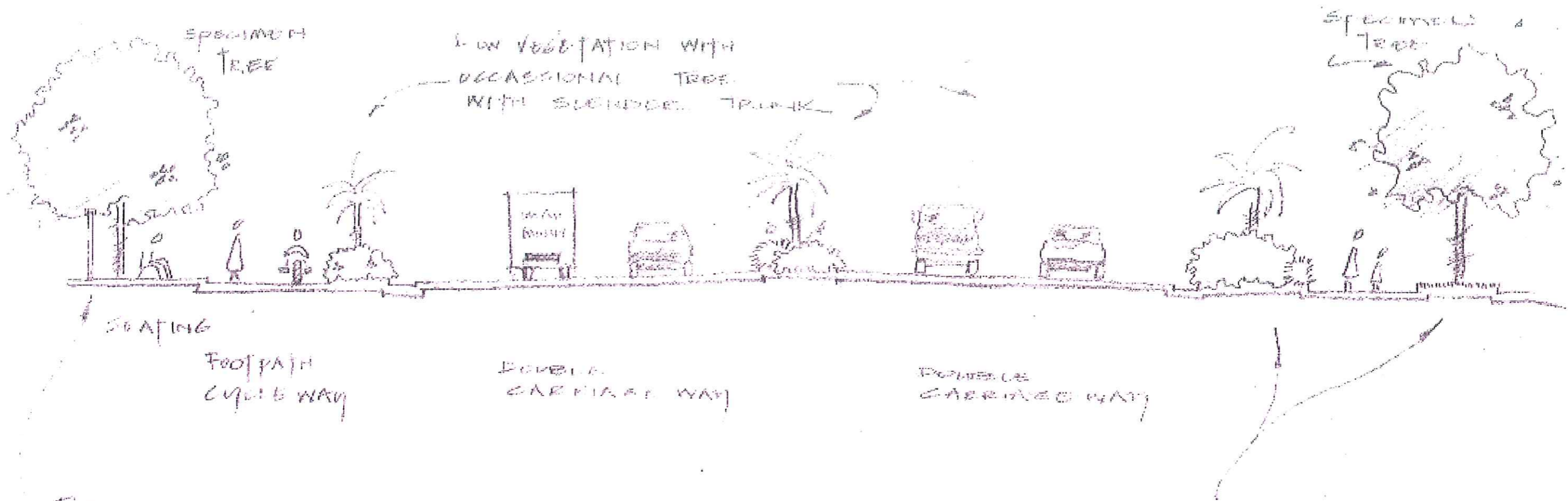

Boundary fence to reflect character of adjacent precinct of 200 ft wide & 100 ft wide B1 Railway Station

Planting buffer between path & carriage way possible near Thomas Burns St a whole harbourside development is still to be resolved

NOTE: The above cross sections will be possible where adjoining amenity borders are most generous i.e.: parts of railway station & harbourside precincts (sheet 3,4); railway corridor (sheet 5); Frederick street roundabout (sheet 6) & in 30 year planting (sheet 7).

CYCLE &  
FOOT ACCESS

MEDIAN PLANTING:  
LOW VEGETATION WITH  
OCCASSIONAL SLENDER  
TRUNKED SPECIMEN  
TREE

VINES, MURELS &  
UPGRADED FENCES  
ON INDUSTRIAL  
BOUNDARY



BOUNDARY FENCES

SPECIAL TREATMENT ADJOINING  
CHINESE GARDENS &

RAILWAY STATION PRECINCTS

— VINES ON MESH FENCE  
IN INDUSTRIAL AREAS

NOTE:

- [1] The above cross sections is applicable where the Strategic Arterial is most constrained by adjoining properties, eg: between Chinese garden & Harbourside Precinct (sheet 2); along industrial boundary south of Frederick street roundabout (sheets 4 & 5); Railway boundary (sheet 6 & 7).
- [2] Establishment of proposed low hedges between non motorised traffic will be dependant upon space available & environmental conditions.