

About the International Library of Children's Literature

The International Library of Children's Literature (ILCL) is the sole national library dedicated to children's literature. The library has three basic roles:

- (1) To serve as a library specialized in children's literature, collecting books for children from Japan and around the world to preserve and utilize them for research.
- (2) To serve as a place where children come in contact with books, providing opportunities to become familiar with libraries and reading.
- (3) To serve as a museum of children's books, introducing all people to the wonders of children's literature.

Arch Building

Built in 2015. The building has a curved exterior.

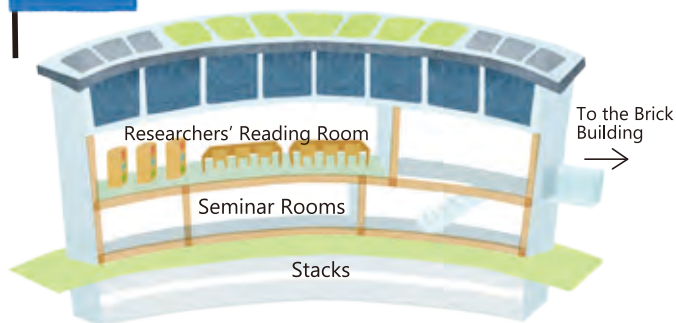

Brick Building

The original Imperial Library building was originally built in 1906 and enlarged in 1929. It is a leading example of Renaissance-style Western architecture during the Meiji period (1868–1912) and has been designated a selected historic structure by the Tokyo Metropolitan Government.

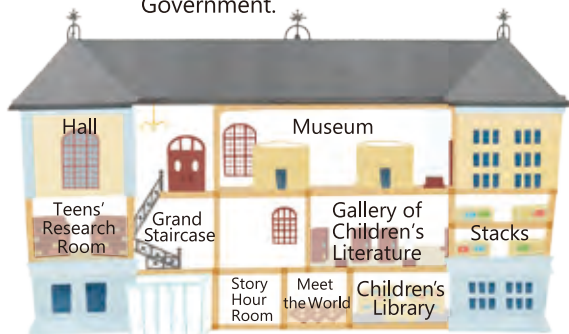

User Guide

Open from 9:30 a.m. to 5:00 p.m.

Reader Services

Reading rooms open from 9:30 a.m. to 5:00 p.m.
Call-slips accepted from 9:30 a.m. to 4:30 p.m.

Photoduplication services

Requests for same-day photoduplication accepted from 10:00 a.m. to 4:00 p.m.
(Includes print out of electronic resources.)

Requests for photoduplication to be delivered by postal mail accepted from 10:00 a.m. to 4:30 p.m.
(Delivery by postal mail or courier service.)

Completed photoduplication requests can be picked up at the Printout Counter from 10:00 a.m. to 12:00 noon and from 1:00 to 4:30 p.m.

Library Closed

Mondays
National holidays
(except Children's Day on May 5)
Year-end and New Year's Holidays
The third Wednesday of each month

Access

A 10-minute walk from the Park Exit of the JR Ueno Station

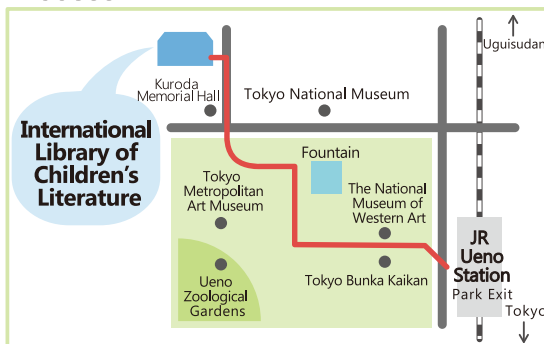

National Diet Library International Library of Children's Literature

12-49 Ueno Koen, Taito-ku, Tokyo 110-0007, Japan
Tel +81-3-3827-2053
Fax +81-3-3827-2043

Website
<http://www.kodomo.go.jp/english/index.html>
Newsletters via email
<http://www.kodomo.go.jp/about/mailmagazine/index.html>

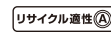

この印刷物は、印刷用の紙へリサイクルして生まれ、

(2018.8)

Welcome to
the National Diet Library's
International Library of
Children's Literature



International Library of Children's Literature
National Diet Library

1F

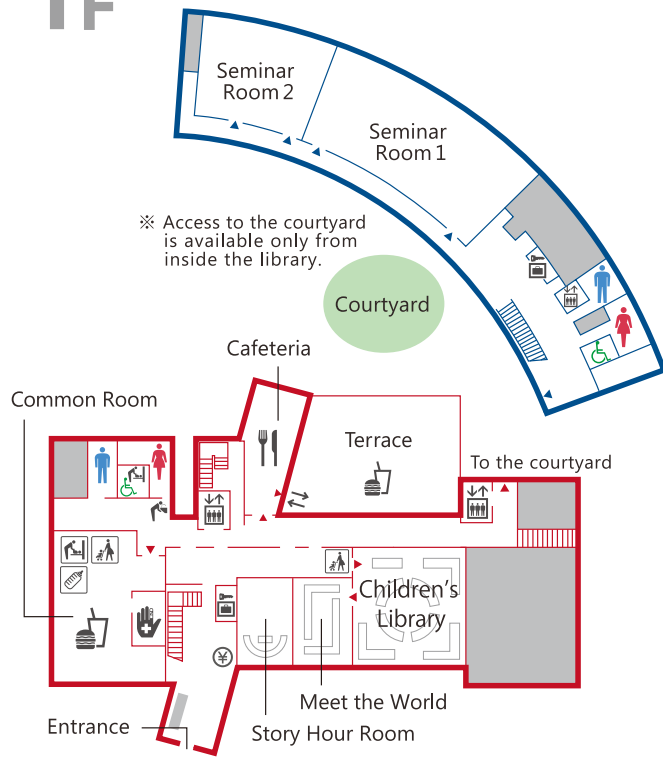

2F

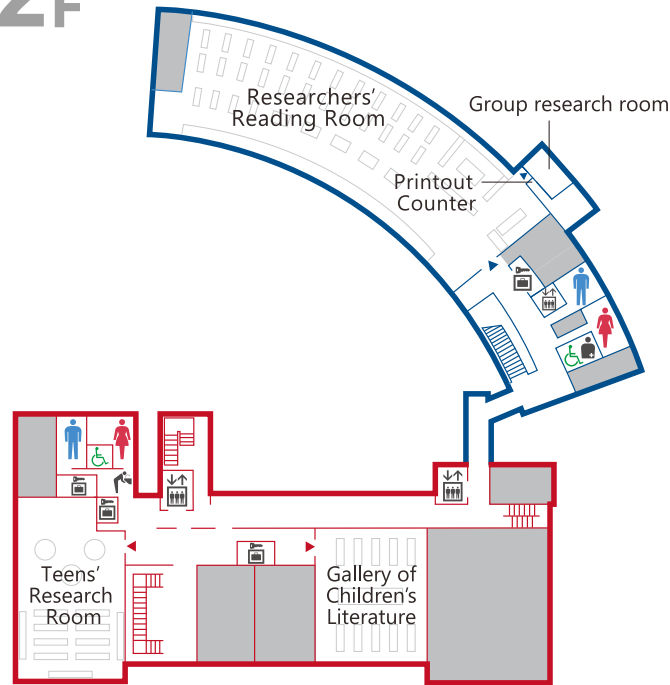

3F

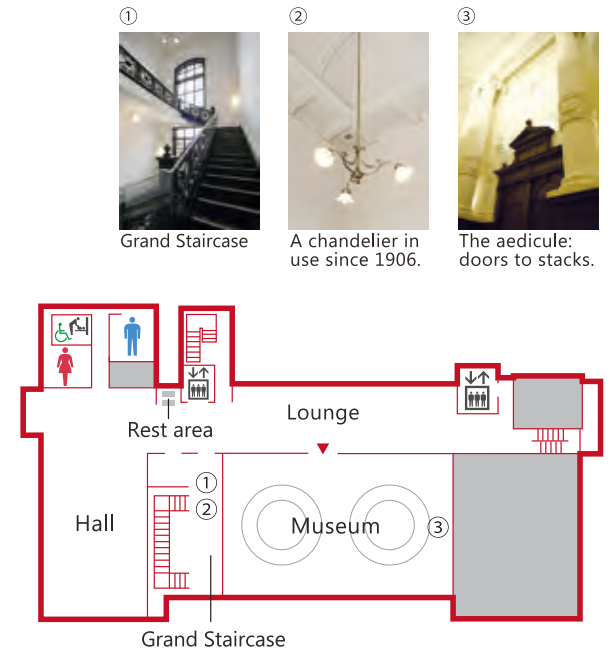

Children's Library

Picture books, story books, and general knowledge books for young readers up to elementary school age are available here.

Meet the World

Books on countries and regions from around the world are available here.

Story Hour Room

Story hour for children is held on Saturdays (except during summer vacation).

14:00 Ages 4 to 6
(Up to first grade)

15:00 Ages 7 and older
(Second grade and older)

Seminar Rooms 1 & 2

These rooms are used for lecture meetings, seminars, and events for children.

Teens' Research Room

Materials useful for teens doing research are available here.

Gallery of Children's Literature

A gallery showing the history of Japanese children's books from the Meiji era to the present is available here.

Researchers' Reading Room

Room for researching children's literature. Registration is required to enter the room. Children's literature published in Japan and abroad, reference materials on children's books, and school textbooks currently used in Japan are available on open shelves. Materials in closed stacks are available upon request.

Hall

In addition to an exhibition on the ILCL, concerts and other events are also held here.

Museum

Exhibitions covering a variety of subjects on books for children are held here.

Lounge

Space enclosed by a glass curtain wall. You can see the original exterior wall and appurtenances.

Stacks

Stacks, located in the brick building and the arch building, can house about one million books (Staff only.).



Please refrain from the following while visiting the Library.

- ▲ Taking photographs where prohibited.
- ▲ Eating, drinking, or talking on the phone except where permitted.
- ▲ No smoking anywhere in the library.

