

A WALK THROUGH TIME

- RVH Expansion
- Community Giving
- Equipment Advances
- Auxiliary
- Nurses' Alumnae
- Historical Significance

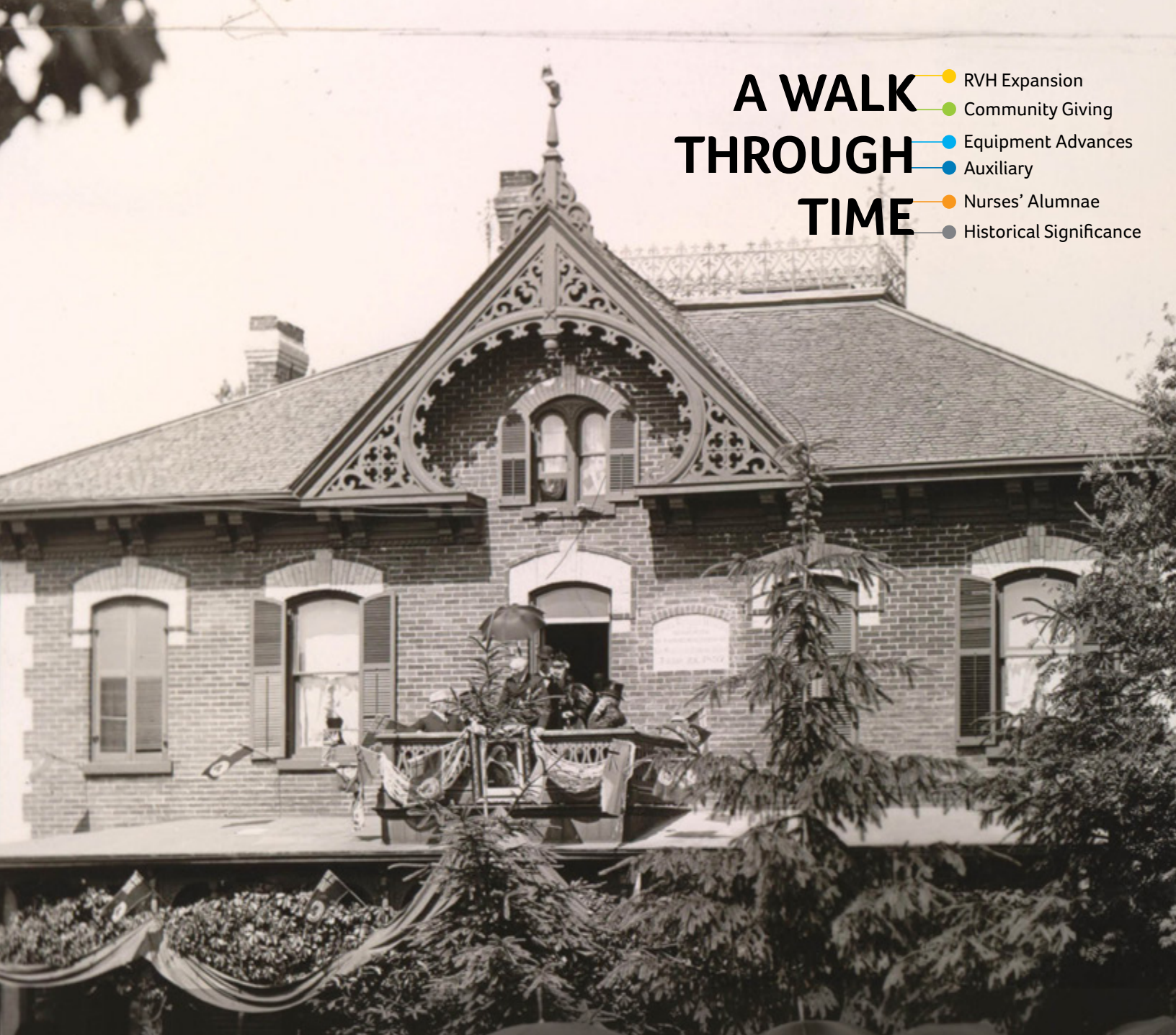

A look back on how far RVH and health care in our community has come since 1897.

RVH has a strong history of firsts. Our advancement in health care innovation is closely linked with ongoing community support.

Help. Make each life better. Together.
<http://foundation.rvh.on.ca/>

A WALK THROUGH TIME

- RVH Expansion
- Community Giving
- Equipment Advances
- Auxiliary
- Nurses' Alumnae
- Historical Significance

1835 ● Dr. Archibald Pass arrives in Barrie as the first doctor. He starts a healthcare movement!

1889 ● The first community undertaking: A group of women come together to raise funds for a hospital in Barrie.

1891 ● The four-bed Barrie General Hospital opens on Duckworth Street at a cost of \$1,000.

1897 ● Queen Victoria's Diamond Jubilee

● RVH opens on High Street at a cost of \$3,000. Barrie's population is 8,000. Local media reports: *"The new 13-bed RVH offers excellent facilities to patients. Rooms are bright, cheery, well-ventilated and lit by electricity."*

● Local church communities partner to raise \$500 to furnish RVH.

● D'Alton McCarthy, a lawyer and politician in Barrie, donates an operating table.

● Royal Victoria Hospital School of Nursing accepts its first two students.

● 1,333 patient visits (in comparison to 450,000 patient visits in 2015).

● Miss Margaret M. Campbell is appointed Superintendent and holds the position until 1901.

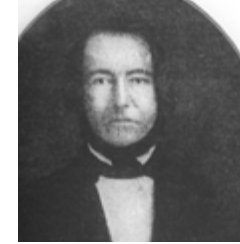
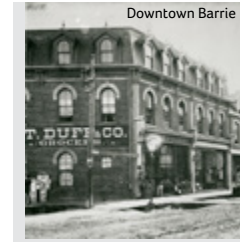

Quintessence and Charles Armstrong
 a short visit to Royal Victoria Hospital
 the building is a fine specimen of
 architecture, clean and airy, and
 well-ventilated. The beds and
 furniture are of the best, and the
 atmosphere is most agreeable.
 The building is a fine specimen of
 architecture, clean and airy, and
 well-ventilated. The beds and
 furniture are of the best, and the
 atmosphere is most agreeable.
 The building is a fine specimen of
 architecture, clean and airy, and
 well-ventilated. The beds and
 furniture are of the best, and the
 atmosphere is most agreeable.



1903

A new 35-bed hospital is built on Ross Street in downtown Barrie at a cost of \$20,000.

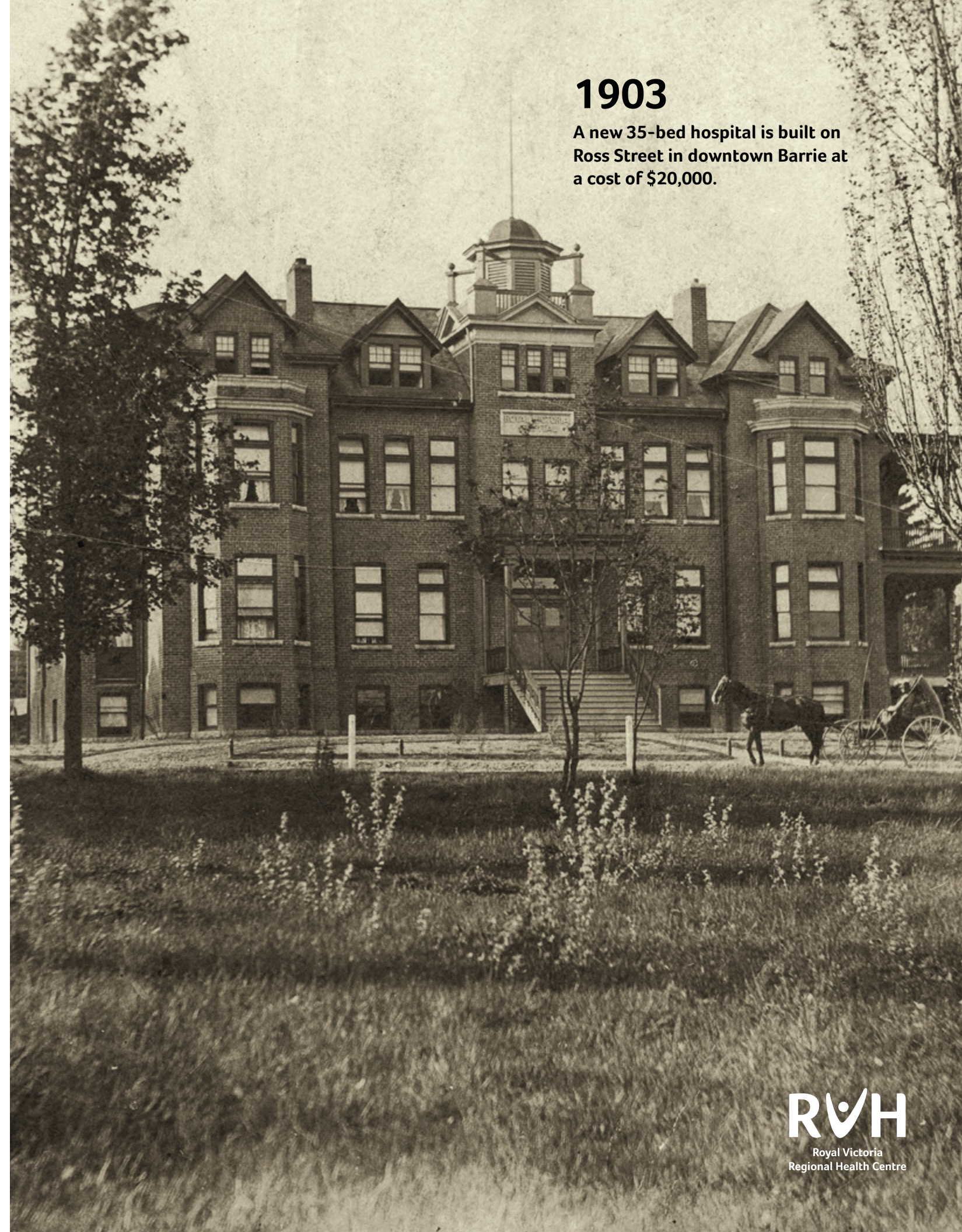

A WALK THROUGH TIME

- RVH Expansion
- Community Giving
- Equipment Advances
- Auxiliary
- Nurses' Alumnae
- Historical Significance

1898 ● Total salaries per month for all staff are \$37.87. Patients are charged \$1.14 per day for care.

1899 ● Donor recognition formally begins with the first donor wall called "The Tablet."

1900 ● RVH installs Barrie's first telephone.



1901 ● Ms. Neta McLennan is appointed Superintendent and holds the position until 1923.

1903 ● New RVH built and opened on Ross Street.

● The 35-bed hospital was built for \$20,000.

● Official opening celebration, local media reports: *"Barrie has indeed much to be proud of in possessing one of the prettiest and most up-to-date hospitals in Canada."*

● First X-ray machine at RVH, local media reports: *"A very interesting feature of the opening ceremonies was the exhibition and demonstration of the (water-driven) X-ray machine."*

● Local media reports: *"Members of the Ladies Auxiliary think it would be a very nice and becoming thing if the wealthy corporation known as the Barrie Hockey Club would undertake to defray the expense of putting rubber tires on the ambulance."*

1910 ●

Henry Hatton Strathy donates \$10,000 (equivalent to approx. \$300,000 today) to create the new Strathy Wing.

Local media reports: *"This striking example of generosity on the part of his son reflects honour on the family while at the same time ministering greatly to the present needs of a worthy institution."*

MR. STRATHY'S GIFT
 Son of Late H. H. Strathy Will Provide Entire Cost of New Wing at R. V. Hospital.
 The Royal Victoria Hospital Trust has been advised by Mr. Gerard B. Strathy, of Toronto, son of the late H. H. Strathy, K.C., that he will stand the entire cost of the proposed new wing, Sixxcoo. This handsome



HOSPITAL MEETING The old officers and board re-elected. The Treasurer's statement was as follows:

(Continued from First page.)

RECEIPTS.	
Ontario Government Grant	\$ 3741.06
County of Simcoe Grant	500.00
Patients	11734.21
Income from Investments, Endowments, etc.	456.00
Subscriptions and Donations, cash	255.52
Dressings and Operating Room	831.20
Outside Nursing	730.00
All other sources	79.77
Total	\$18327.76

SUBSCRIPTIONS AND DONATIONS.	
Union Thanksgiving Collection	\$ 15.52
Dr. Arnall	3.00
Brown & Co.	5.00
H. A. Sims	3.00
Dr. Little	5.00
Harry Paik	3.00
Bell Telephone Co.	6.00
Rev. Dean O'Malley	5.00
Rev. D. D. McLeod Estate	200.00
J. D. Wisdom & Co.	5.00
F. R. Porritt	5.00
Total	\$ 255.52

EXPENDITURES.	
Bank Overdraft, 1916	\$ 32.56
Meat, Powl, Fish, Bacon	892.10
Butter and Eggs	1054.20
Flour, Bread and Meal	598.67
Milk	521.48
Potatoes and other Vegetables	709.89
Groceries and Provisions not enumerated	1396.95
Drugs and Medicines	388.91
Medical and Surgical Appliances	466.42
Surgical Instruments	93.35
Bedding, Napery and Housefurnishings	618.23
Brooms, Brushes, Mops and Cleaning	218.28
Light—Oil and Candles	225.61
Fuel—Coal, Wood, Gas	3627.52
Water Supply	114.94
Ice	90.60
Salaries	4150.35
Taxes and Insurance	161.60
Contingencies	474.48
Repairs, ordinary	397.91
Repairs, extraordinary, Alterations, Additions	115.60
Power for Elevator	89.66
Discharging Mortgage	1256.69
Bank Charges	5.15
Cash in Bank	635.90
Total	\$18327.76



HOSPITAL REPORT
 To the Editor:—The Board of Directors of the Royal Victoria Hospital have set apart June 3rd (King's Birthday) for a one-day canvass to raise funds for a new electric elevator for the hospital. The tower will be divided into sections and between 50 and 60 ladies will participate in this whirlwind campaign to raise \$1500 for this most commendable improvement in the Hospital equipment.

WHIRLWIND CANVAS FOR NEW ELEVATOR
 The W.A. of the R.V. Hospital have set apart June 3rd (King's Birthday) for a one-day canvass to raise funds for a new electric elevator for the hospital. The tower will be divided into sections and between 50 and 60 ladies will participate in this whirlwind campaign to raise \$1500 for this most commendable improvement in the Hospital equipment.

At present the only elevator in the building, the equipment of which is most modern in every other respect, is simply a freight elevator. This is operated by hand, and is so noisy as to disturb patients, and at the best it is but a crude affair. The new electric elevator will place the R.V. Hospital in the front rank as regards equipment, and is a forward more worthy of support.



1911 ● Strathy Wing is completed with 35 beds.

1912 ● Dr. Ernest G. Turnbull is appointed to medical staff and later becomes RVH's first Chief of Staff, playing a key role in organizing the Victorian Order of Nurses (VON) in Barrie.

1914 ● The First World War begins.

RVH purchases its first automobile in order to transport patients.

Equipment upgrades, local media reports: *"The hand-powered elevator is so noisy it disturbs other patients and is a crude affair. The new electric elevator will place RVH in the front rank with regards to equipment."*

1915 ● The 1st Canadian Division reaches France in February, 1915.

Early on during the First World War, the Women's Auxiliary focuses on obtaining more hospital equipment to meet upcoming military demands.

1917 ● RVH purchases its first stove.



1918 ● The First World War ends November 11, 1918.

RVH purchases the latest X-ray machine for \$2,495.

A WALK THROUGH TIME

- RVH Expansion
- Community Giving
- Equipment Advances
- Auxiliary
- Nurses' Alumnae
- Historical Significance

1921 ● The Roaring Twenties begin.

- Donor support makes safe surgery a reality with the purchase of an Electric Sterilizing Unit.

- RVH installs multiple phone lines which allow for communication across the hospital. Local media reports: *"The exchange takes care of seven telephones - it connects with phones in the nurses' home, diet kitchen, Miss McLennan's apartments, and the chart room."*

- RVH's first major operation - an appendectomy under local anesthesia - is successful.

1923 ● Miss C. Smith is appointed Superintendent and holds the position until 1925.

1925 ●

Miss Clarke is appointed Superintendent and holds the position until 1927.

Miss Helen Shanahan is appointed Assistant Superintendent until 1946.

1927 ●

- Barrie politician, Leighton McCarthy and *Globe and Mail* owner, W.H. Wright, make an investment in education by donating a total of \$13,000 to build and furnish the McCarthy Nurses Residence on Ross Street.

- Miss J.K. McArthur is appointed Superintendent and holds the position until 1937.

1928 ● Mayor of Barrie, W. A. Boys, donates a gas-oxygen machine to RVH (an upgrade from the use of ether) to ease patient pain.

Mayor of Barrie, W. A. Boys:
"Gas-oxygen is one of the safest anesthetics in use [and] does not exhaust a patient to the same degree as the ether does."

1929 ● The Great Depression begins.

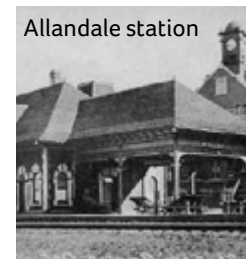

Helen Shanahan



A WALK THROUGH TIME

- RVH Expansion
- Community Giving
- Equipment Advances
- Auxiliary
- Nurses' Alumnae
- Historical Significance

1935 ● The Great Depression lingers.

Patient lengths of stay reach an all-time high of 35-40 days. Average cost per patient each day is \$2.66.

1936 ● The first woman is elected to the RVH Board of Directors - Mrs. V.E. Knight.

1937 ●

- L.G. McCarthy donates \$10,000 in memory of his mother. The third floor of the hospital is converted into a maternity ward and a new elevator is installed.

- Miss Scheiffle is appointed Superintendent and holds the position until 1938.

1938 ● Miss Elsie William is appointed Superintendent and holds the position until 1946.

1939 ● The Great Depression ends and the Second World War begins.

A major bequest of \$5,000 from Albert Taylor Cooper is made to pay for the hospitalization of Barrie's needy children.

1945 ● The Second World War ends on September 2, 1945.

The wonder drug penicillin is available for the first time.

1946 ● Helen Shanahan is appointed as Superintendent and holds the position until 1965.

1949 ● A blood bank refrigerator is donated by the Kiwanis Club of Barrie.



A WALK THROUGH TIME

- RVH Expansion
- Community Giving
- Equipment Advances
- Auxiliary
- Nurses' Alumnae
- Historical Significance

1950 ● RVH experiences approx. 30,000 patients visits.

Patients pay for their own care and Public Ward rates rise from \$3.75 to \$4 per day.

1951 ● From 1948-1951, *Globe and Mail* owner, W.H. Wright donates \$190,000 (equivalent to approx. \$2 million today) for the new Memorial Wing in honour of Canadian soldiers in the Second World War.

W.H. Wright:
"If there is one thing which Barrie and district needs more than any other, it is up-to-date hospital accommodation...There have been extraordinary advances in medical science in recent years. We now need more facilities to bring these into practice for the lasting good of humanity."

1952 ●

- Citizens of Barrie and district contribute an amazing \$250,000 (equivalent to approx. \$2.5 million today) to help finance the Memorial Wing construction.
- Walter Laidlaw donates \$21,000 to furnish the Laidlaw Residence.
- RVH's Memorial Wing is built, adding 70 beds to the hospital.
- The nurses' Laidlaw Residence is built and opens with 58 beds.

1954 ● The Hospital Auxiliary buys an oxygen tent.

1959 ● Dr. Anita Carol Beaton, Barrie's first female doctor moved to Barrie and went on the form the first Department of Anesthesia and was Chief of staff for many years.

1962 ●

- The Ross Street RVH is expanded.
- The Gables property is donated by Walter Laidlaw to RVH.



Premier Leslie Frost and Nancy Craig: opening the new RVH Wright Wing
 Credit: George Frost

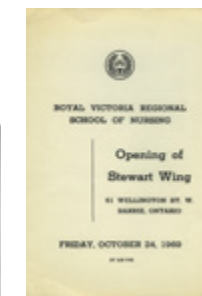
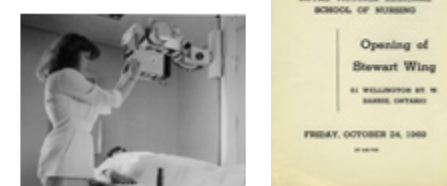
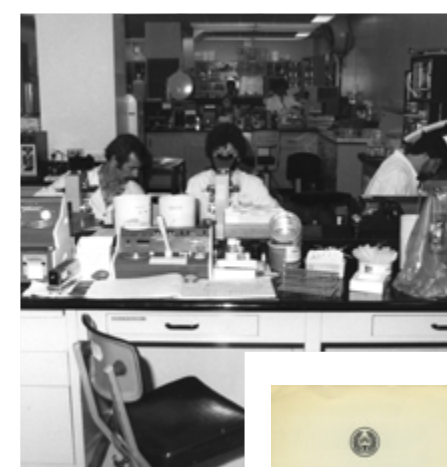

A WALK THROUGH TIME

- RVH Expansion
- Community Giving
- Equipment Advances
- Auxiliary
- Nurses' Alumnae
- Historical Significance

1963 ●

- The first of two additions is constructed to increase hospital capacity.
- The new Laboratory opens.
- Victoria's Gift Shop opens, the *Barrie Banner* reports: *"The gift shop is equipped to satisfy leisure time of the sick... many of the articles on sale are products of the Auxiliary members' talents over recent months."*

1965 ●

- The Hospital Auxiliary is renamed as "The Royal Victoria Hospital Auxiliary".
- RVH is chosen as a Regional Nursing School. Ninety nursing students are enrolled.
- Helen Shanahan retires from lifelong position at RVH.
- Mr. Donald S.F. Cameron appointed Chief Administrator and holds the position until 1980.

1966 ● Medical Care Act starts in Ontario.

1967 ● Infant Intensive Care Unit opens.

The Barrie Examiner:
"One of four existing nurseries at the hospital will likely be remodeled later this year to improve services offered to sick infants."

1968 ●

- Local media reports: *New Equipment Places RVH Among Best in the Province – "The most expensive piece of equipment is a \$54,000 X-ray machine that can be tilted forward, backward and sideways."*
- New lighting for surgery rooms.
- The last class of the Royal Victoria Hospital School of Nursing graduates. Over 71 years 770 nurses graduated.



A WALK THROUGH TIME

- RVH Expansion
- Community Giving
- Equipment Advances
- Auxiliary
- Nurses' Alumnae
- Historical Significance

1969 ● RVH introduces its first ambulance fleet.

The Barrie Banner:
Province Wide Ambulance Service at RVH – “Early next month a third ambulance will be added to the fleet that now operates out of RVH.”

1970 ● The 70s and 80s bring advancements in Imaging.

The purchase of a gastroscope and colonoscope provide an alternative to X-ray and exploratory surgery for detection and biopsies.

1971 ● Barrie Cancer Society presents a bequest from the estate of Dr. Hugh Quackenbush.

1975 ●

- Auxiliary purchases operating microscope, laparoscope, colonoscope and a cardiac monitor.
- Fetal monitor was purchased at a cost of \$4,400.

1977 ● RVH starts a trial helicopter ambulance service.

1979 ●

- Auxiliary donates funds for an ultrasonic instrument cleaner.
 RVH Auxiliary:
“An ultrasonic instrument cleaner is one of the most dependable cleaning methods used to pre-clean instruments.”
- An \$80,000 ultrasound unit comes to RVH.
- RVH uses approx. 3,000 instruments daily.

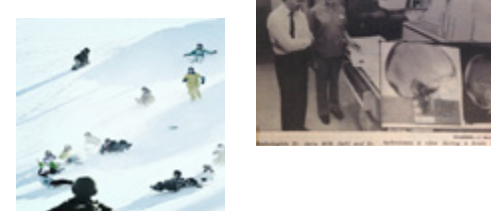

A WALK THROUGH TIME

- RVH Expansion
- Community Giving
- Equipment Advances
- Auxiliary
- Nurses' Alumnae
- Historical Significance

1980 ● Mr. Ted Long is appointed as President & CEO and holds the position until 2004.

1982 ● The RVH Foundation is established.

1983 ● Foresters donation buys heart monitor.

1985 ●

- New Critical Care and Emergency units are added for \$4 million.
- New angiogram comes to Barrie with help from the “Angie Fund”.
 Local media reports:
“The unit allows technicians a view during a brain scan without the problems of distortion or the restrictions of a single X-ray photograph.”
- The Canadian Cancer Society’s Ron Carter presents RVH with a \$70,000 mammography X-ray.

1986 ● The Auxiliary tops off the Foundation’s \$1 million Angie Fund with a donation of \$75,000.

1987 ●

- Building on a Century capital campaign begins.
- M*A*S*H Bash begins at Snow Valley and raises \$480,000 over 29 years.
- Crystal Classic golf tournament begins and raises \$2.6 million over 29 years.
- RVH plans expansion.

1989 ●

- RVH Auxiliary pledges \$1 million to Building on a Century.
- Educational Trust Fund is established.

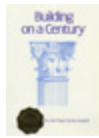



1995

The construction on Georgian Drive was made possible by the Building on a Century capital campaign. Contributions from the community and a combined donation of \$37.8 million from local governments made the new hospital possible.

1997



A WALK THROUGH TIME

- RVH Expansion
- Community Giving
- Equipment Advances
- Auxiliary
- Nurses' Alumnae
- Historical Significance

1990 ● RVH plans a new life on Georgian Drive.



1991 ● Café Royale opens on Ross Street next to the Emergency department and grows into the Café Royale we know today in the Main Lobby of the RVH Expansion on



1996 ● First Dynamic Digital 1000 Interventional X-ray Unit.



RVH Intercom:
"The unit received a 'Most Innovative New Product Award' from the Radiological Society of North America."

1997 ● ● ● ● ● ● Royal Victoria Hospital celebrates 110th birthday!

- Following an ambitious \$15 million fundraising campaign and over 15 years of lobbying, the \$125 million RVH opens with 500,000 square feet on Georgian Drive.
- On September 22, 1997, after a year of planning, a 100-person RVH move team performs one of the biggest medical transfers in the history of Ontario. The move to the new hospital includes:
 - 150 patients
 - Two ultrasound units
 - Three X-ray units
 - One fluoroscopic unit
 - Three nuclear medicine machines
 - Two mammographic units
 - One computerized tomography (CT) scanner
- A Magnetic Resonance Imaging (MRI) machine arrives at the new RVH and is the most expensive piece of equipment ever purchased at \$2.5 million.
- Hospital's average length of stay dramatically declines, from a 10-day stay for a gallbladder removal to an "in and out" procedure.
- By the numbers:
 - 105,000 patient visits
 - 275 physicians
 - 2,161 staff
 - 1,000 volunteers



A WALK THROUGH TIME

- RVH Expansion
- Community Giving
- Equipment Advances
- Auxiliary
- Nurses' Alumnae
- Historical Significance



2012
 RVH Phase 1 Expansion project opened May 17, 2012.
 The \$450 million expansion doubled the size of the existing hospital.

I Believe campaign

Throughout the 'I Believe' capital campaign our community came together through a combination of loyal donors and first-time givers. Families, businesses and service clubs came together to make more than 33,500 individual contributions, raising over \$35 million.



A WALK THROUGH TIME

- RVH Expansion
- Community Giving
- Equipment Advances
- Auxiliary
- Nurses' Alumnae
- Historical Significance

2012

- RVH opens expansion at a cost of \$450 million. Janice Skot, President & CEO: *"It is no understatement to say this redevelopment will transform healthcare in Simcoe Muskoka."*
- After treating patients from across the region, Royal Victoria Hospital of Barrie is officially renamed Royal Victoria Regional Health Centre.
- More than 500 people gather for the official opening ceremony of the RVH expansion.
- 'I Believe' campaign exceeds \$35 million goal.
- 400,000 square feet is added to RVH, doubling its size. Much planning and research resulted in a facility that provides safe, high quality patient care in a bright and healing environment.
- 100,000 square feet of renovations in the existing facility.
- \$70 million in advanced equipment and technology.
- The Simcoe Muskoka Regional Cancer Centre opens with 75,000 square feet of space, offering chemotherapy and radiation treatment.
- New Respiratory Inpatient unit opens - a new department for RVH.
- New Cardiac & Renal Inpatient unit opens.
- New Cancer & Palliative Inpatient unit opens.
- Imaging Services doubles in size with two new MRIs, two Interventional Radiology (IR) suites, four new digital mammography suites and two new single photon emission computed tomography (SPECT) CTs.
- Emergency department triples in size with two specialized trauma rooms and seven additional trauma rooms with direct access to an expanded ambulance bay. Three mental health observation rooms and on-site crisis team are incorporated.
- Seven-bed Cardiac Care Unit (CCU) opens - the only one of its kind in the region.
- RVH's Laboratory becomes fully automated - a first in Canada.
- RVH's Rotary Place opens and is named in recognition of the \$1.5 million in contributions made by Rotary Clubs throughout the region.
- Rotary House cancer lodge opens for cancer patients traveling from outside Barrie to receive care at RVH.

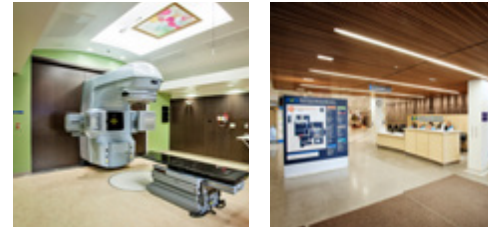

A WALK THROUGH TIME

- RVH Expansion
- Community Giving
- Equipment Advances
- Auxiliary
- Nurses' Alumnae
- Historical Significance

2013

- New Ultrasound department. Dr. Scott Good, RVH's Chief of Imaging: *"It is now the most advanced and well-equipped Imaging department in the region."*
- Two new operating rooms open with smart technology, providing high definition image-guided surgery.
- Endoscopy suite expands.
- RVH acquires 19 new dialysis machines.
- Victoria's Gift Shop expands to a new storefront in the Atrium Entrance.
- RVH Auxiliary completes its \$1.5 million pledge to the CCU.

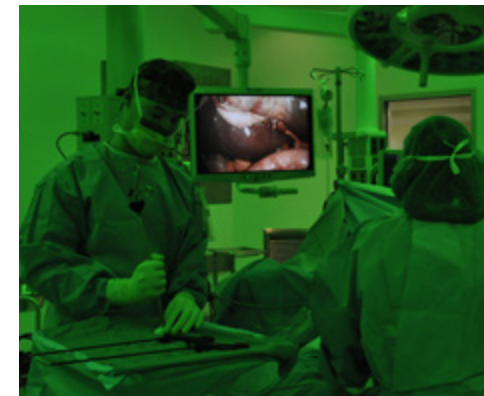

2014

- RVH opens 10th operating room.
- Women's cancer services begin at RVH with plans to expand the program.
- RVH Auxiliary announces a \$2 million pledge to help bring advanced cardiac care, and child and youth mental health services.

Katherine Bacik, first women's cancer patient:

"I have two small children and having to travel to Toronto for treatment for my cervical cancer would have placed a huge burden on my family," says the Alliston mother.

"This is such a phenomenal opportunity to have this kind of care close to home."

A WALK THROUGH TIME

- RVH Expansion
- Community Giving
- Equipment Advances
- Auxiliary
- Nurses' Alumnae
- Historical Significance

2015 ● Hearts & Minds campaign launches.

- Hearts & Minds campaign launches to raise \$25 million for five priority areas in the health centre - advanced cardiac care, child & youth mental health, women's cancer services, equipment, and teaching and research.
- \$2.6 million donation (largest RVH donation made by a living individual) - Ron Joyce through Joyce Foundation for a hybrid operating suite.
- David and Mary Crook donate \$1 million toward the Advanced Cardiac program at RVH.
- Media for Young Minds campaign pledges \$50,000 to child and youth mental health at RVH.
- LCI's, Radio for Cardiology pledges \$500,000, totalling \$1.5 million in support of RVH.
- Ontario Premier Kathleen Wynne visits RVH to announce the official "green light" to develop an Advanced Cardiac program in partnership with Newmarket's Southlake Regional Health Centre and the Cardiac Care Network.

2016 ●

- The presidents of the Rotary Clubs of Barrie, Barrie Huronia and Kempenfelt pledge \$625,000 to the Hearts & Minds campaign.
- New CT scanner is installed. Dr. Chris Guest, Interim Medical Director and Chief of Imaging Services: *"CT scanners are indispensable tools for the diagnosis and treatment of disease."*
- Three mobile X-rays are installed to help care for patients in the Emergency department, Intensive Care Unit and Neonatal Intensive Care Unit.
- In-hospital dialysis begins at RVH.
- RVH opens its doors to visitors 24/7, recognizing families as an important part of the care team.
- Ontario's Minister of Health and Long-Term Care, Dr. Eric Hoskins, announces \$9.1 million in capital funding to start construction on the Advanced Cardiac Centre.
- By the numbers:
 - 450,000 patient visits
 - 385 physicians
 - 2,500 staff
 - 850 volunteers

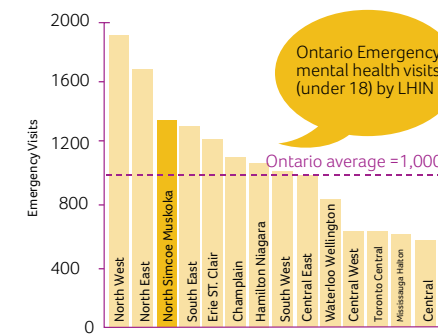
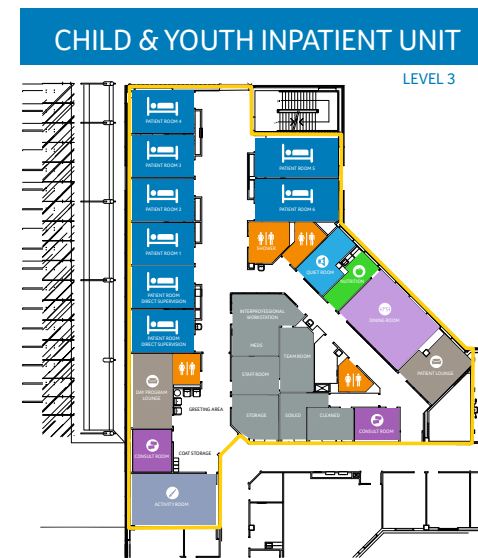
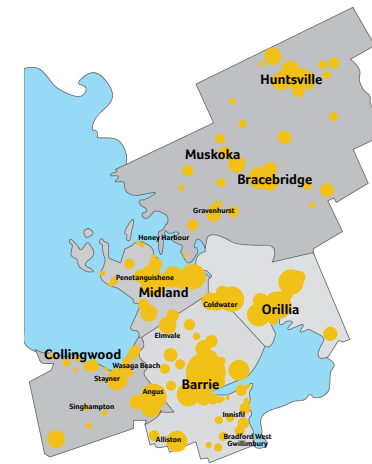
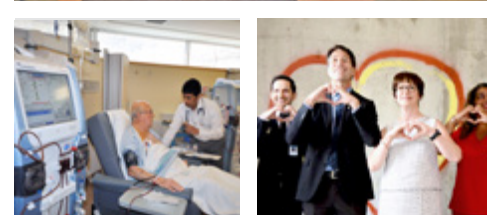
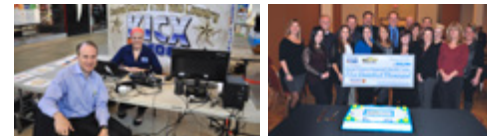

A WALK THROUGH TIME

- RVH Expansion
- Community Giving
- Equipment Advances
- Auxiliary
- Nurses' Alumnae
- Historical Significance

THE FUTURE OF CHILD & YOUTH MENTAL HEALTH

The need is now: North Simcoe Muskoka (NSM) has growing rates of children and youth experiencing a mental health crisis

- One in five youth experience a mental health challenge
- Over 1,750 NSM children and youth presented to Ontario Emergency departments with a mental health concern in 2015-2016
- Suicide is the second leading cause of death for NSM youth - That is 45 per cent higher than the provincial average
- Early intervention is key - 70 per cent of mental illness begins in childhood or adolescence

RVH has a plan

- RVH has already completed significant work, along with our partners in education, justice and the community who endorse a regional Child & Youth Mental Health program at RVH
- RVH continues to build our team of specialized child and youth mental health professionals
- The program will be part of an expanded network of hospital, community and education partners who work together to provide a comprehensive continuum of mental healthcare for children and youth
- In October 2015, RVH opened its Urgent Consult Clinic (UCC)

Program will include:

- A child and youth-friendly, eight-bed inpatient unit
- Capacity to admit up to 300 youth as inpatients each year
- A day hospital program enabling patients to go home at night and still get specialized care
- Crisis team access

If children and families reach out for help, we need to be there

- \$3 million in community support is needed
- \$3.2 million in funding is required from the Ministry of Health and Long-Term Care to operationalize a regional child and youth mental health program on an annual basis
- RVH will provide \$5 million in capital funding to construct the program



A WALK THROUGH TIME

- RVH Expansion
- Community Giving
- Equipment Advances
- Auxiliary
- Nurses' Alumnae
- Historical Significance

THE FUTURE OF ADVANCED CARDIAC CARE

The need is now: Access to Advanced Cardiac Care for North Simcoe Muskoka residents (NSM)

- In 2013/2014 there were 8,700 cardiac chest pain patients including 3,750 EMS ambulance calls in NSM
- 1,100 severe code “STEMI” heart attacks
- Only 76 patients were able to transfer directly to a cardiac centre (Southlake Regional Health Centre in Newmarket) for immediate intervention

RVH has a plan

- Advanced cardiac care at RVH will include diagnostics, treatment and rehabilitation
- Recruited a highly-skilled team of cardiologists, specialized nurses, educators, rehabilitators and program administrators
- Developed a comprehensive partnership agreement with Southlake Regional Health Centre
- Opened a dedicated 32-bed Cardiac & Renal Inpatient unit and the region’s only 7-bed Cardiac Care unit
- Dedicated space in the 2012 expansion that only requires patient fit out

Program will include:

- Two catheterizations labs allowing lifesaving angiograms and angioplasty
- Heart Function and Urgent Cardiology clinics
- A centralized cardiovascular information system
- Cardiac and renal equipment upgrades to advanced technology

When it comes to your heart, time is muscle - Advanced Cardiac Care is needed closer to home

- \$15 million in community support is needed
- \$9.1 million in one-time capital funding received from the Ministry of Health and Long-Term Care

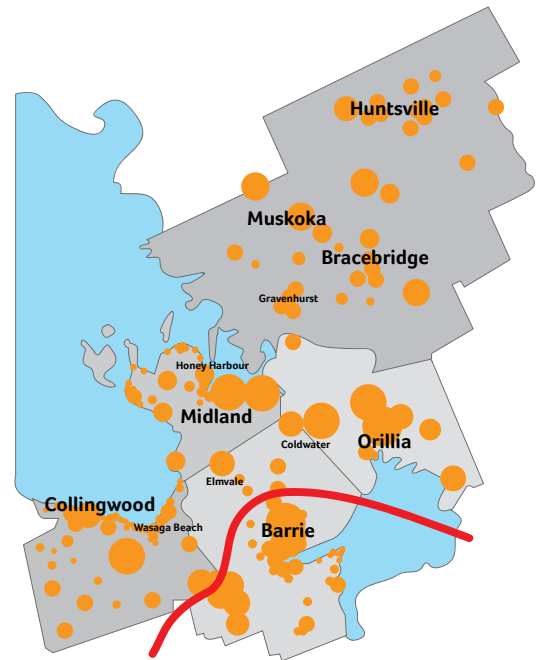

Only patients below this red line are able to have the “gold standard” of care, meaning they can reach a cardiac centre within 90 minutes of a cardiac event.

Ambulance transport is one of over 100,000 cars that travel HWY 400 everyday - increasing to over 125,000 cars during the summer months.

